

PXRD 2D End Station - Sample Environment

Rev	Notes	Created By	Appr. Date

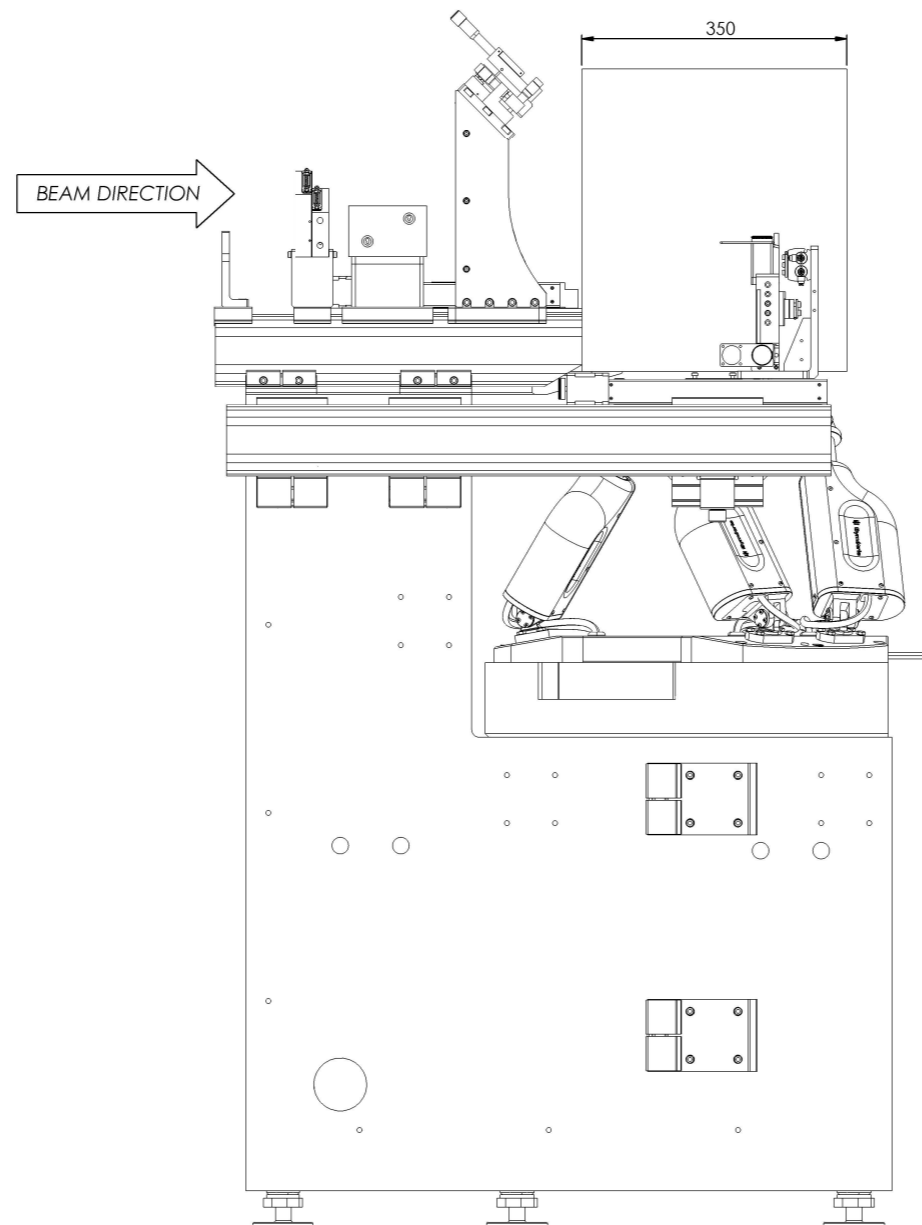

MAXIMUM ENVELOPE SIZE
FOR SAMPLE SETUP

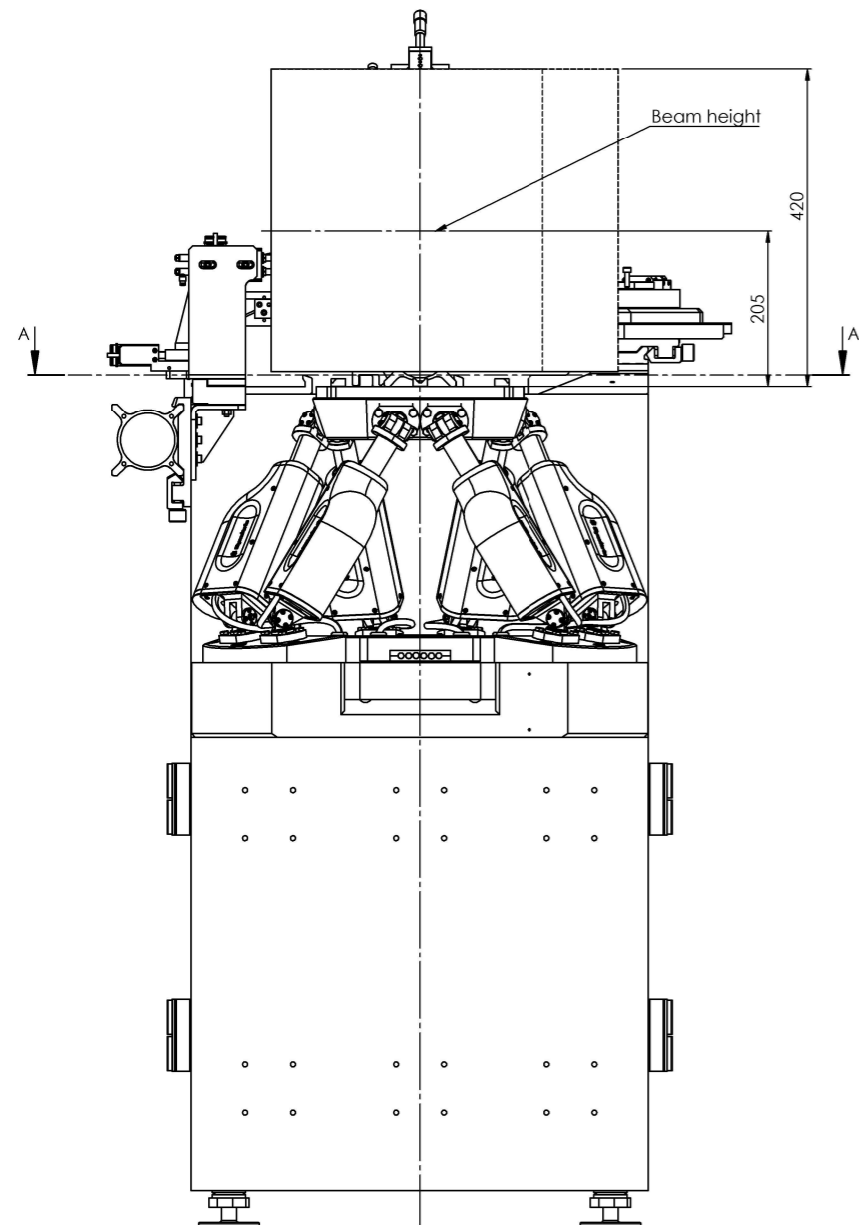
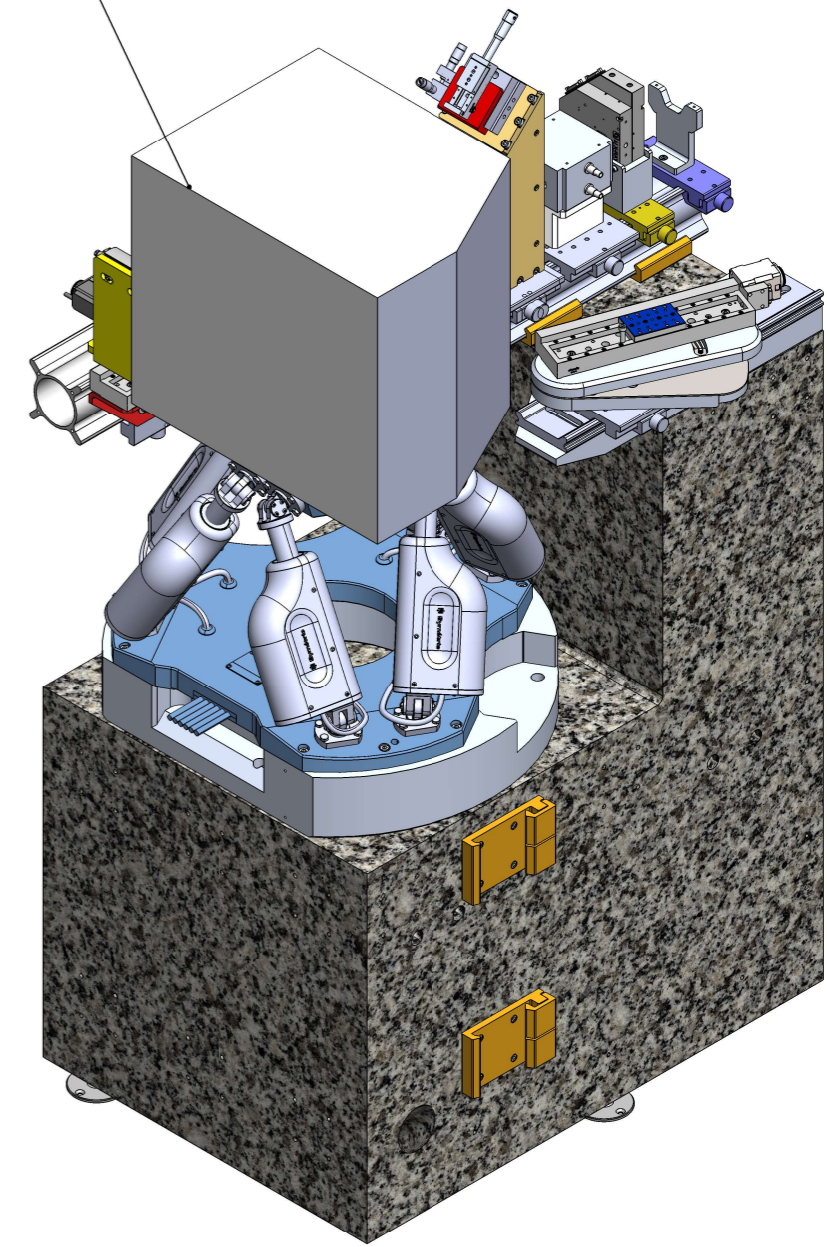

SECTION A-A
SCALE 1 : 5

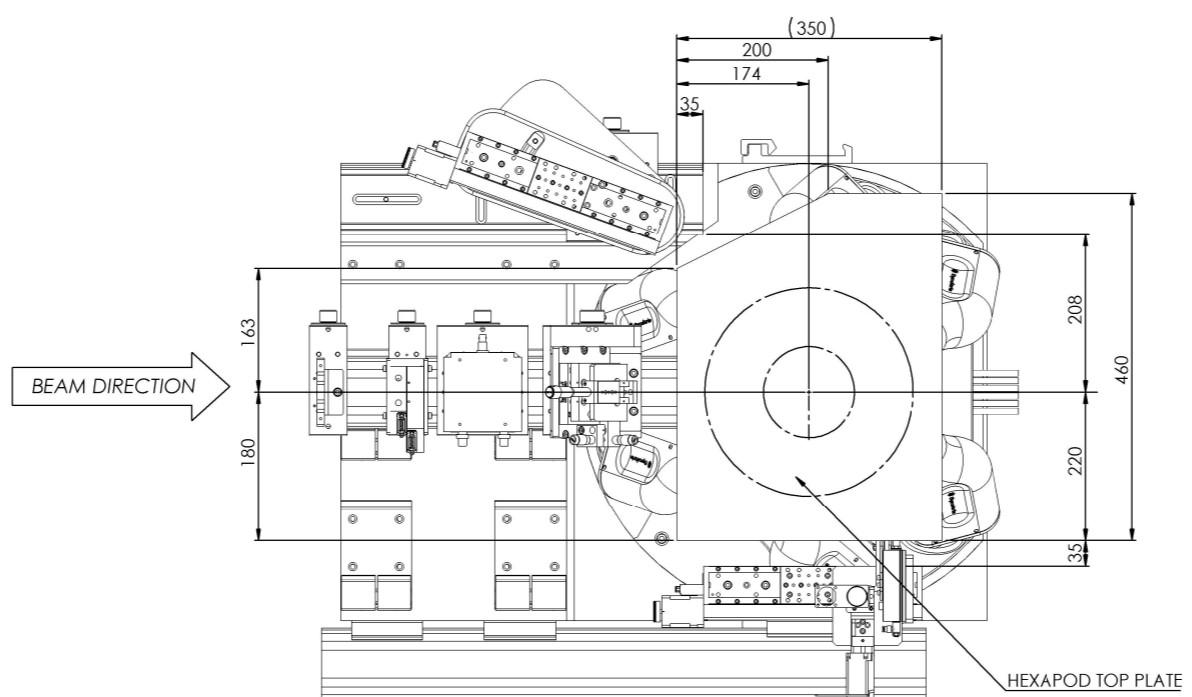
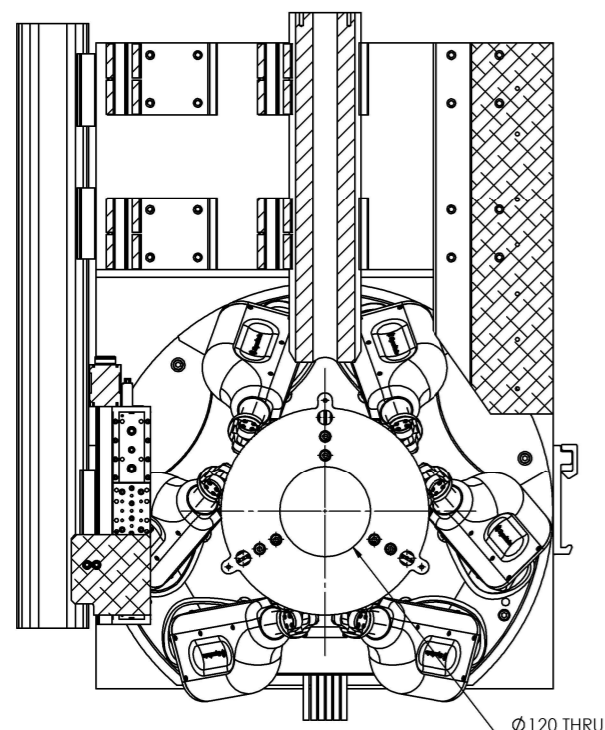

Designer Sforcat	Date 2020-08-26	Tolerance SS-ISO 2768-1 m	Material	Weight 755.97 kg	Scale 1:5	Format A1	Page 1/2
PXRD 2D Instrument EH1 DanMAX R3-B04-EH1 DanMAX				Revision 235668 A			

SAMPLE SETUP BOTTOM PLATE

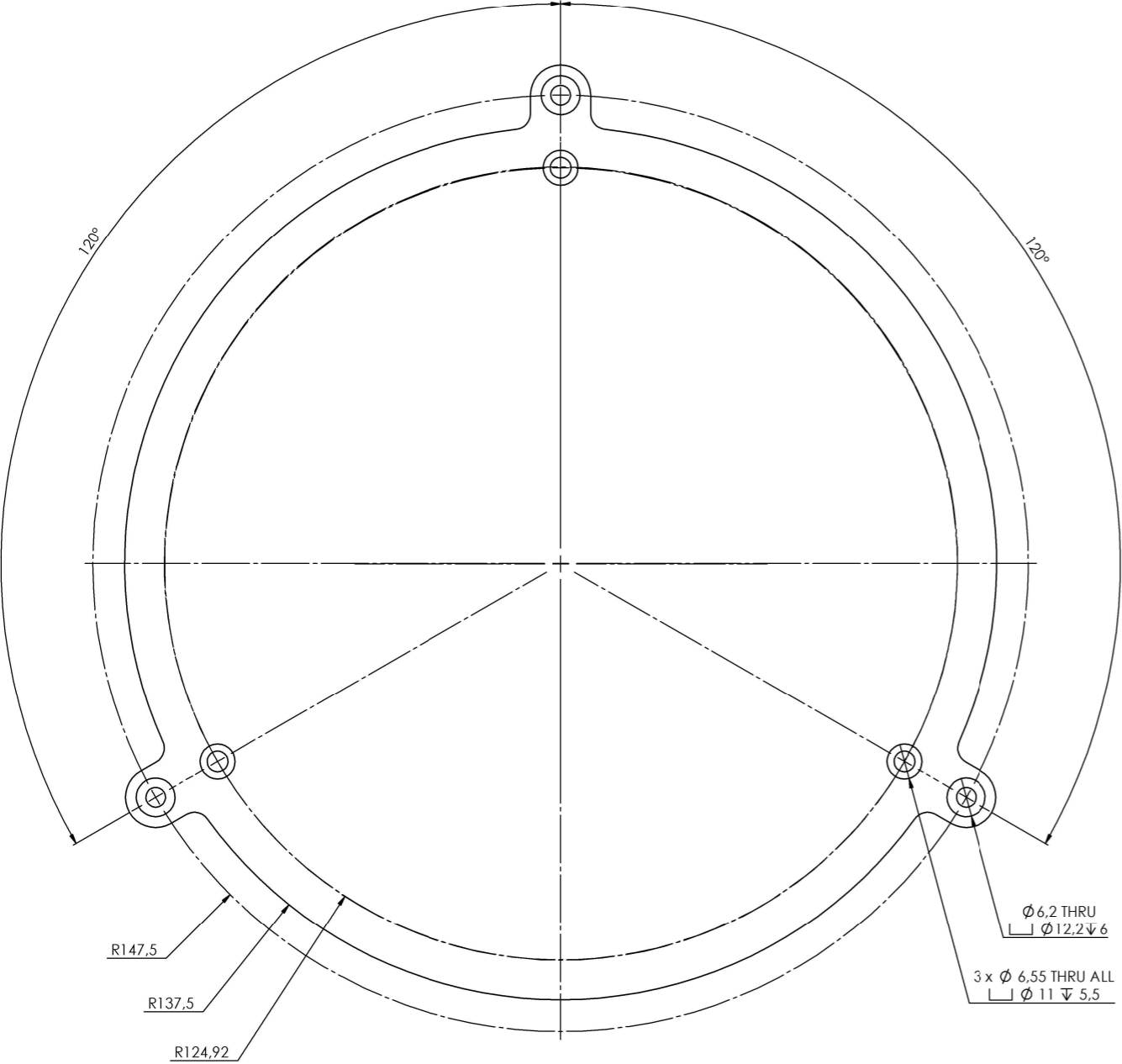

If complete 1/2" balls are used:

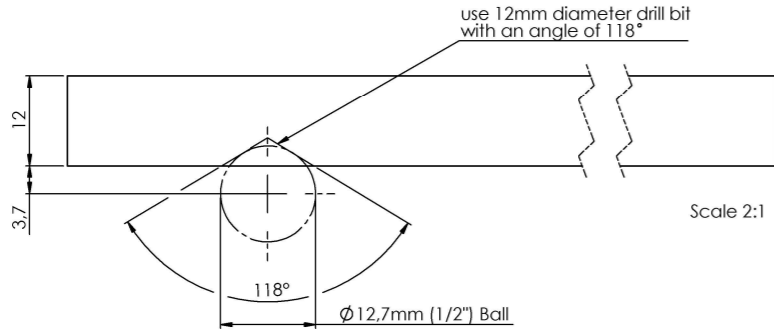

SAMPLE SETUP BOTTOM PLATE
(USERS PLATE)

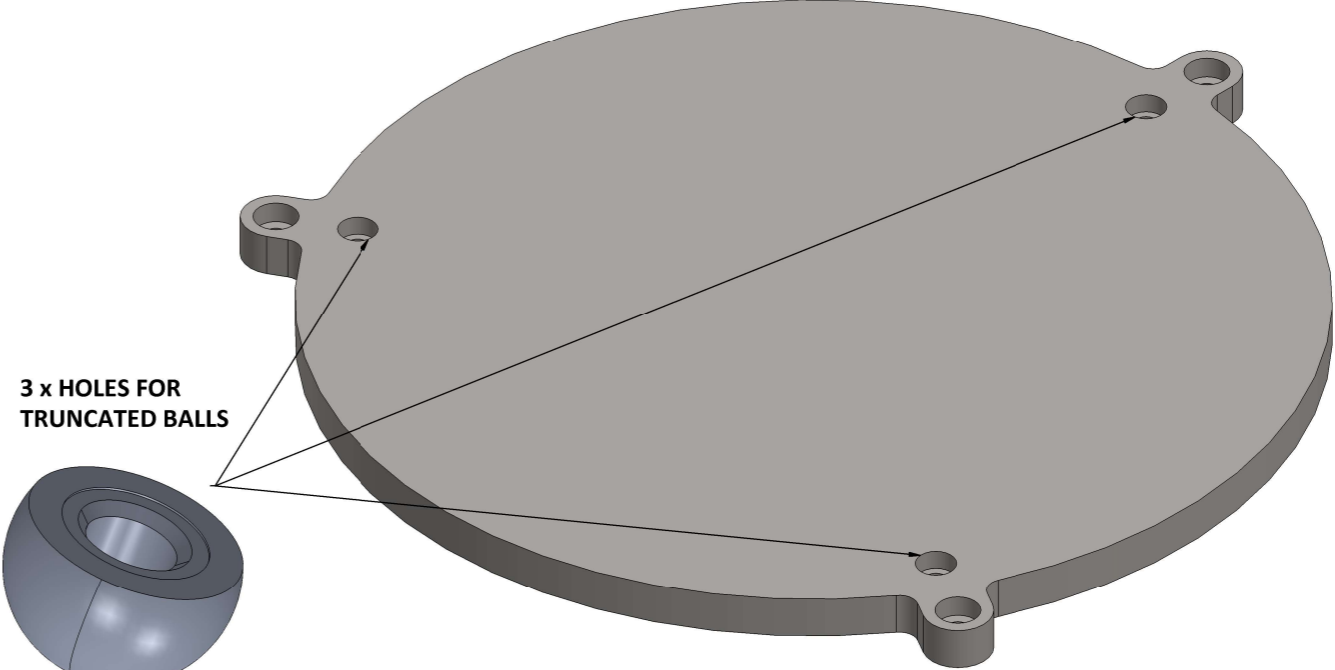

SCALE 5:1

BEAMLINE HEXAPOD INTERFACE
(BEAMLINE)

3x M6 THRU HOLES
FOR FIXTURE

SCREWS TO
TOP HEXAPOD PLATE

3x FIXING SCREW M6

3 x SURFACE MOUNTED VEE BLOCKS

Vee Blocks for 5/16" (0.3125", 7,94mm) through 1/2" (0.500", 12,7mm) balls
Supplier: Bal-tec, Part number VB-375-SM

Designer Sforcat	Date 2020-08-26	Tolerance SS-ISO 2768-1 m	Material	Weight 7.05 kg	Scale 1:1	Formal A1	Page 2/2
MAXIV LABORATORY		Kinematic Mount PXRD 2D Instrument EH1 DanMAX		Revision		235668 A	